

# Green Living™ Technologies, LLC

*Green Living™ Roofs*  
*Green Living™ Walls and Accessories*

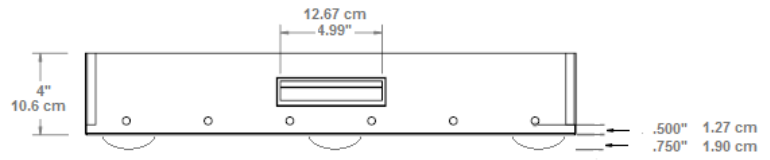
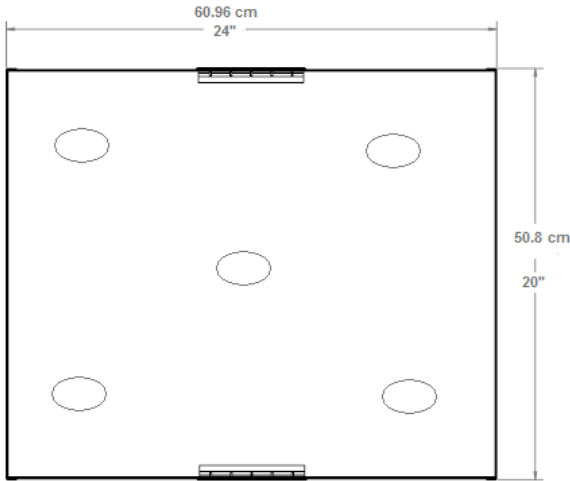

ALSO AVAILABLE IN 6" and 8" DEPTHS

CAN BE CUSTOMIZED TO ADD ADDITIONAL WATER RETENTION FOR ADDITIONAL STORM WATER RETENTION AND CONTROL

- Constructed of heavy duty (.05") recycled / recyclable aluminum, stainless and zinc. (Please specify)
- .750" embossed feet allow for air flow and drainage under the Green Living Roof Tray
- Complete with water retention mat(s)
- Minimum 3" growing media depth
- Planted in Place or Pre-Vegetated Options available

EMPTY WEIGHT = 3.98 lbs

WATER RETENTION AS SEEN = 4.35 +/- \*gallons (16.5 liters +/-) \*Can be increase with additional Water Retention Mat

SATURATED WEIGHT = 52.5 lbs (15 lbs per sf)

**GREEN LIVING™ ROOF TRAY  
SINGLE PLY MEMBRANES**

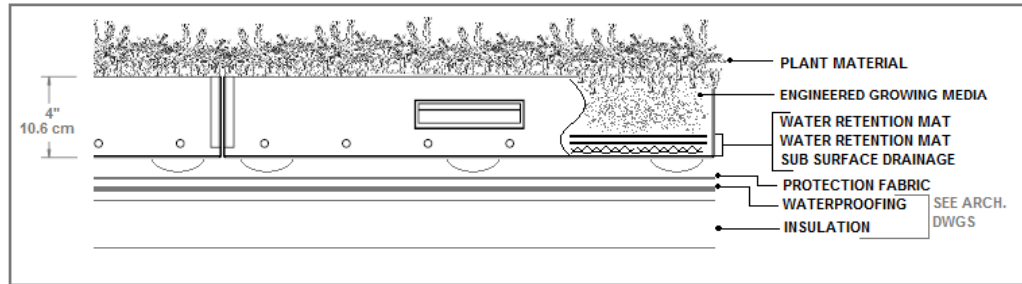

**GREEN LIVING™ ROOF TRAY  
PROTECTED MEMBRANE APPLICATION**

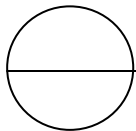
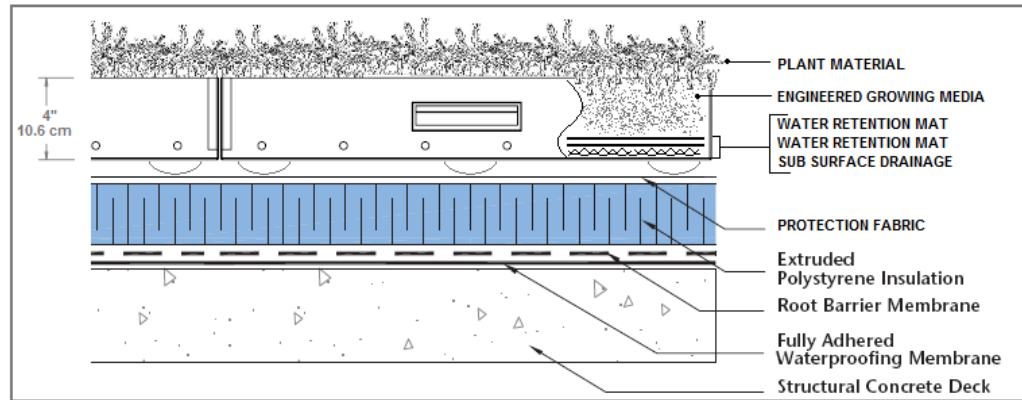

## Green Living™ Roof Tray Details and Installation Details

### Green Living™ Technologies, LLC

191 Imperial Circle  
 Rochester New York 14617  
 800-631-8001 [www.agreenroof.com](http://www.agreenroof.com)

DO NOT SCALE

